

Autodesk Certified User: Inventor 2023 - Metric

- This exam has **30 - 35** questions.
- The maximum exam time is **50** minutes.

The exam experience follows this process:

1. **Tutorial.** The tutorial provides helpful information.
2. **Exam Questions.** The exam timer starts and the questions appear. You can move forward and back through them, answer them, and mark them for review or feedback.
3. **Exam Ends.** The exam timer stops and the exam ends.
4. **Feedback.** You can leave feedback.

Autodesk Certified User: Inventor Metric

Exam Interface and

When the question section is

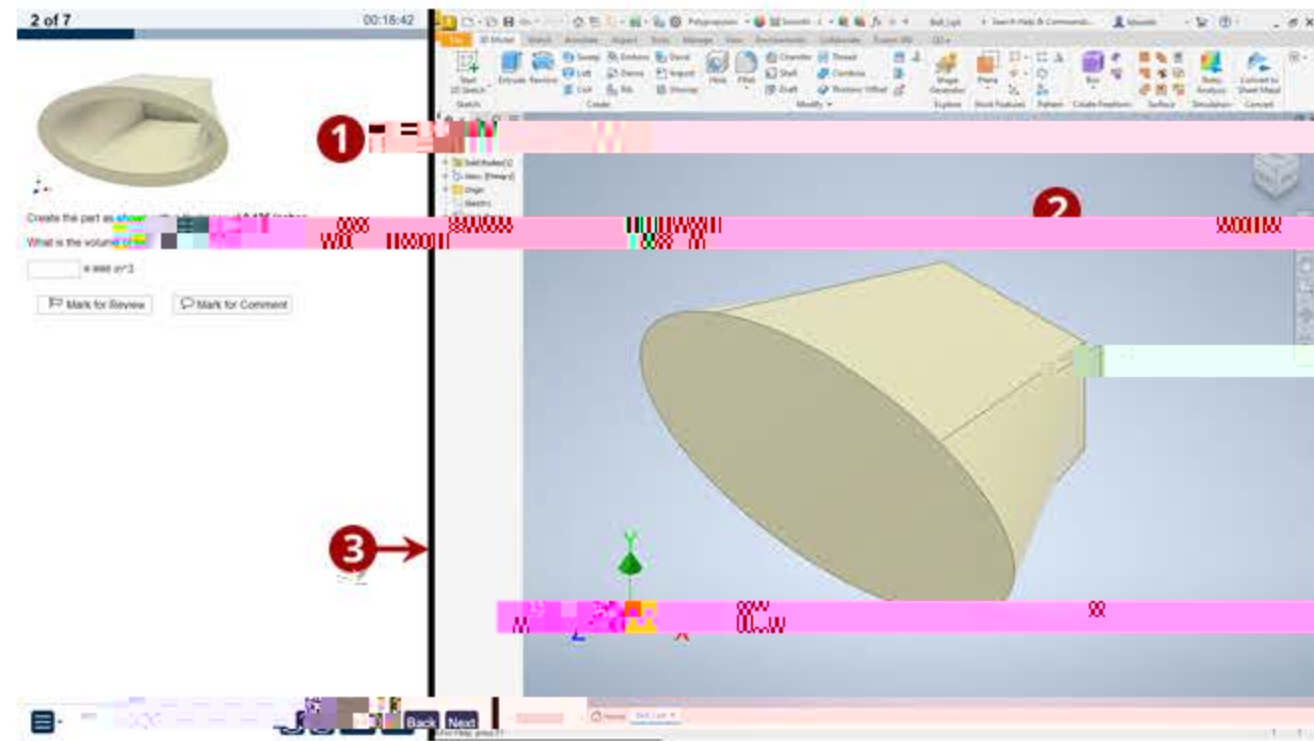

You can change the size of the exam panel by dragging the vertical edges

between the

If you click Restore Down

can be moved to a second monitor.



Autodesk Certified User Inventor Metric

Exam Panel

The exam panel has three panes, the Information pane, the Content pane, and the Navigation pane.

1 **2 of 7** 00:16:18:42

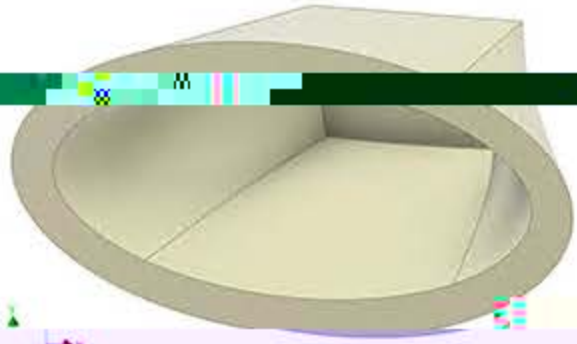

Create the part shown with a thickness of 0.125 inches.

What is the volume?

Mark for Review

Mark for Comment

3

1 The **Information** pane at the top of the exam panel shows the current question number, the total number of questions, and the remaining exam time. The progress bar has to indicate the percentage of questions answered.

2 The **Content** pane in the center of the exam panel shows the question and the question image. The question image is the current question image.

3 The **Navigation** pane at the bottom of the exam panel shows the navigation icons.

Question Options

On the exam panel, when you expand a question, you will be able to see instructions for what tasks to perform. Questions have been answered and questions you have marked for review. Each question includes the options described below.

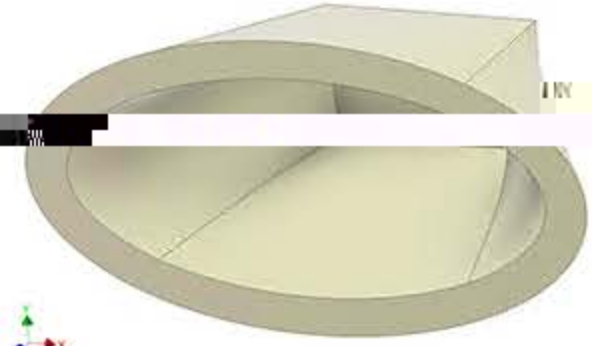

Create the part as shown with the following dimensions:

What is the volume of the part (in cubic inches)?

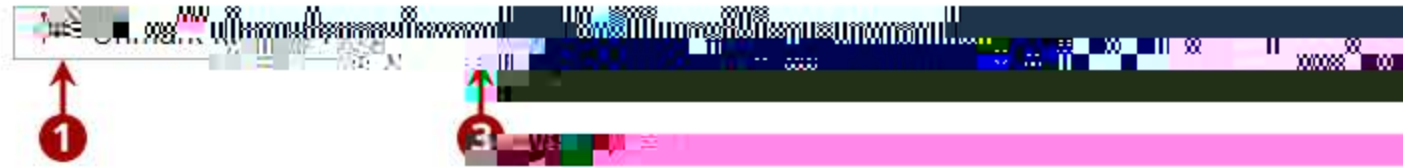

1 Mark/Unmark for Review This question is marked for review. This question is not marked for review on the Exam Summary page.

- #.### mm indicates an answer of 1.234 millimeters
- #.### in indicates an answer of 1.234 inches
- #.### in^2 indicates an answer of 1.234 square inches

Additional Instructions

- Although you are allowed to copy values and paste them into the exam, you need to be aware that answers are not case sensitive.
- Decimals can be expressed by either period or commas.
- Leading or trailing zeros will not affect your score.
- If the exam panel is too narrow to display the content, you can scroll horizontally on the exam panel.
- You can use Ctrl(+) and Ctrl(-) to control the size of the content within the exam panel. Ctrl+0 will reset the content in the exam panel to the default size.

Tools

Skip Tutorial Back Next

Navigation Panel

The Navig...



These buttons collapse into icons as you decrease the width of the exam panel.



The **Tools** menu contains the following options:

- Go To Summary: This option takes you to the Exam Summary page.
- Instructions: This option gives you instructions on how to take the exam.
- Calculator: This option displays the calculator.
- Color Scheme: This option allows you to change the color scheme to Black on White or White on Black.

2 Reload File: Load a fresh copy of the exam. This option is only available if you have not yet started the exam.

3 Restart: If for any reason you are unable to complete the exam, you can restart the exam. This option is only available if you have not yet started the exam.

4 Back: Loads the previous exam data file. This option is only available if you have not yet started the exam.

5 Next: Advances to the next exam data file. This option is only available if you have not yet started the exam.

Feedback

After you submit a question, you can leave feedback about that question.

Expand a question and select the Leave Feedback button to leave feedback about that question.

The screenshot shows a question interface with a feedback modal open. The question is "1 of 7" and asks "What is the volume of the part shown in the image?" with a "1.245" input field. The feedback modal is a dark blue box with a white border, containing a text area for feedback and "Cancel" and "Submit" buttons. The "Next" button is visible at the bottom right of the question area.

When you finish leaving feedback on the feedback period ends.

This is the end of the tutorial. Select **Start Exam** to leave the tutorial and start your exam. You can only begin the exam once you have completed the tutorial.